

# PRODUCT DATA SHEET

## RMW2.2G24D-EZ - 3400 RPM

### DESCRIPTION

This plunger pump will pump up to 2.2 GPM at 2400 PSI. It spins at 3400 RPM in a direct drive system coupled with a gasoline engine. The matching flange provides convenient connection to most 7/8" shaft 1.1 - 5.5 HP engines. The hollow shafted pump includes a built-in pressure control valve, and chemical injection system. With EZ start valve.



### SPECIFICATIONS

MAX GPM ..... 2.2  
MAX PSI..... 2400  
POWER EBHP ..... 3.6  
STROKE MM ..... 8.3  
MAX TEMP ..... 140°  
INLET THREAD ..... 3/4" GH

MAX LMP..... 8.3  
MAX BAR ..... 166  
BORE DIA. MM ..... 12  
WEIGHT LBS..... 7.5  
OIL CAPACITY..... 2.2 OZ  
DISCHARGE THREAD ..... 22MM

### DIMENSIONS

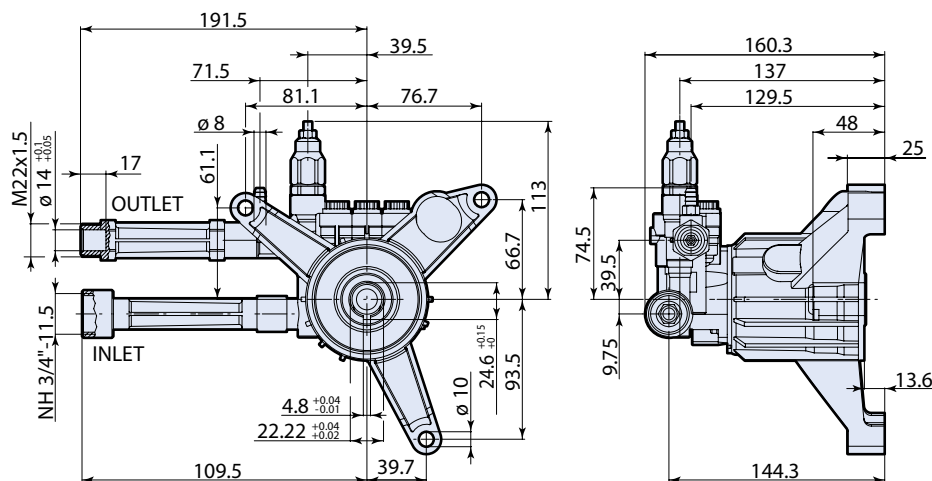

Measurements are - mm

### FEATURING

**Manifold:** Forged brass for long term use.

**Bolts:** Three 6mm cadmium plated steel.

**Plungers:** Hardened stainless steel.

**Valves:** Stainless steel poppet, seat and cage, stainless steel spring.

**Seals:** Buna-N dual seals.

**Bearings:** Premium oversized ball and needle bearings.

**Crankshaft:** Precision die-cast, with cooling fins for maximum heat dissipation. The housing retains the crankshaft bearing, oil seal and rear wobble plate bearing support washer.